

# CSIDE POOLS

CSIDE special models

PRICES 2024 

Prices valid until revoked.  
Selling prices in EUR incl. 25,0 % VAT.

CSIDEPOOLS.EU

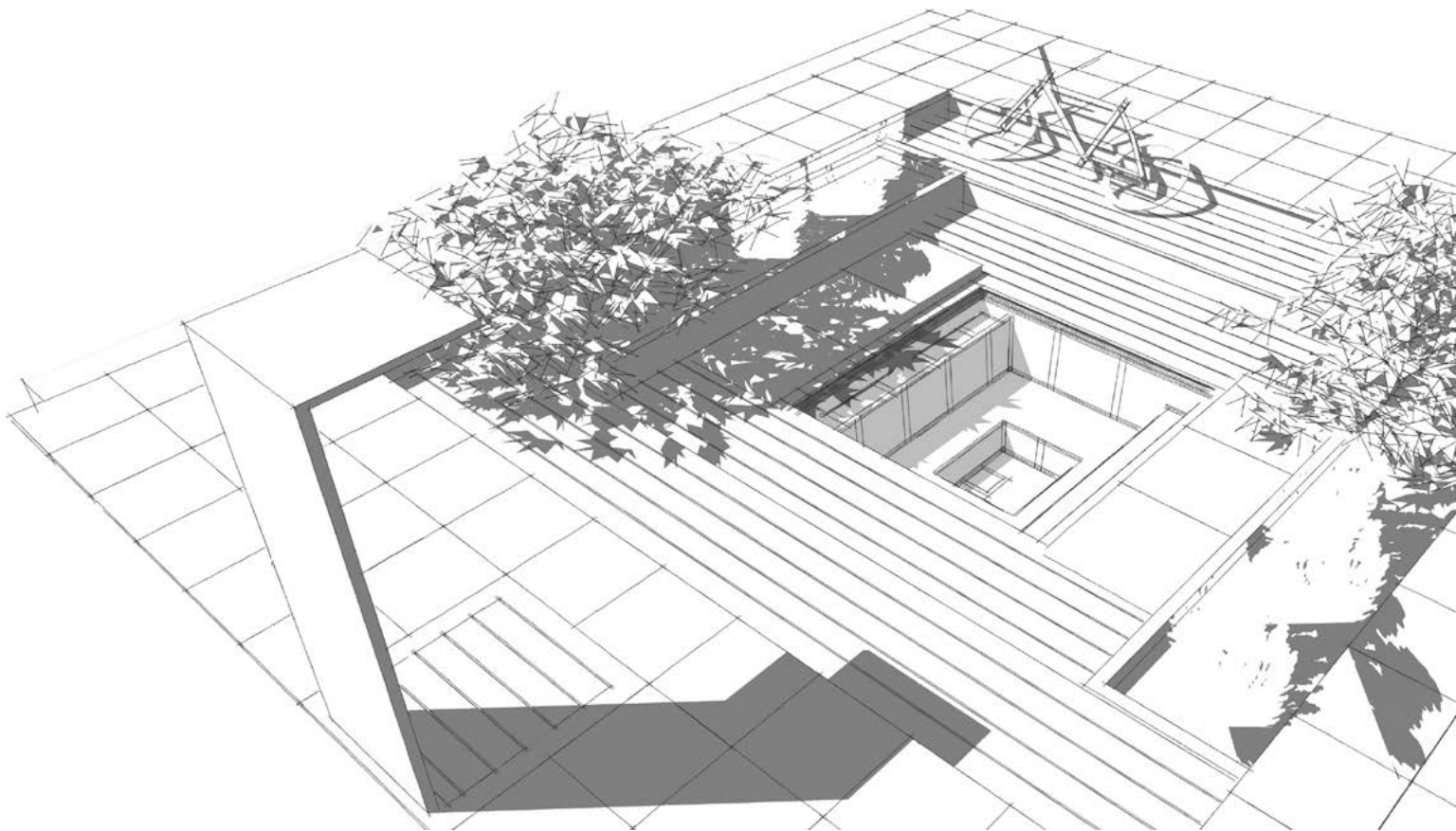

## CSIDE special models

### Article included

- Equipment package

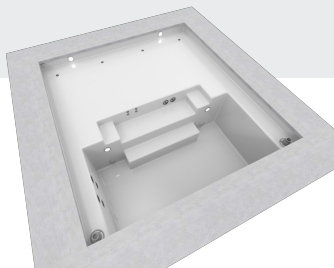

### CSIDE 37 L + SHALLOW WATER ZONE

Dimensions inside:  
**4,10 x 3,70 x 1,27 m**

silver grey

**21.187 EUR**  
CS37FL-FWZ124

papyrus

**21.187 EUR**  
CS37FL-FWZ108

Granicite stone grey

**22.810 EUR**  
CS37FL-FWZ122

Mosaic tiled

**36.996 EUR**  
CS37FL-FWZ130

<b>Accessories</b>	<b>CSIDE 37 L + SHALLOW WATER ZONE</b>
<b>Equipment package</b>	-
<b>Aqua Fun 4.0</b>	<b>5.725 EUR</b> CS600003300
<b>Cascade "Maine"</b>	<b>2.684 EUR</b> CS600003001
<b>Cascade "Cube"</b>	<b>3.550 EUR</b> CS600003200
<b>Spa-Massage-Pak</b>	<b>2.358 EUR</b> CS600007000
<b>4 x vertical inlets</b>	<b>593 EUR</b> CS600004001
<b>Other</b>	<b>CSIDE 37 L + SHALLOW WATER ZONE</b>
<b>Manual vacuum cleaner</b>	<b>231 EUR</b> 7010003
<b>Suction fitting d130</b>	<b>221 EUR</b> CS4205010
<b>Bottom outlet, elbow 90°</b>	<b>273 EUR</b> 4205110
<b>Spare cartridge</b>	<b>79 EUR</b> L817-3501
<b>Inlet fitting 1 1/2"</b>	<b>310 EUR</b> 3133121
<b>Piping material</b>	<b>252 EUR</b> CS600040010
<b>surface care set</b>	<b>147 EUR</b> 6451010
<b>water care set HTH</b>	<b>263 EUR</b> CS600030050
<b>Coping</b>	<b>CSIDE 37 L + SHALLOW WATER ZONE</b>
<b>Copng stones Granite, grey for CS 37+ shallow water zone</b>	<b>4.711 EUR</b> CS370040130
<b>Dekor-Fliesen für CSide37L mit Wetlounge</b>	<b>1.964 EUR</b> CS370001160

Technical equipment	CSIDE 37 L + SHALLOW WATER ZONE
Technique shaft XL	<b>1.943 EUR</b> CS600002001
Technical package for half-year use	<b>1.765 EUR</b> CS600002210
Heat pump HKR 6 kW	<b>1.865 EUR</b> CS600010004
Technique shaft XXL, incl. preparation for dosing system (dosing system not included)	<b>2.679 EUR</b> CS600002003
Terminal for Spatouch display	<b>462 EUR</b> CS600060020
Surcharge for electric heater 9 kW	<b>1.155 EUR</b> CS600008020
Technical package with Spatouch-display	<b>3.519 EUR</b> CS600002225
Lighting	CSIDE 37 L + SHALLOW WATER ZONE
WetLounge lighting in warm white	-
WetLounge lighting in RGB	-
Surcharge for 1x LED RGB light	<b>956 EUR</b> CS600006011
Surcharge for 2 x LED RGB light	<b>2.059 EUR</b> CS600006111
Additional underwater light LED warm white	<b>893 EUR</b> CS600005111
Freight	CSIDE 37 L + SHALLOW WATER ZONE
Surcharge for fixed date (day) delivery	<b>205 EUR</b> CS920000140
Surcharge for delivery by a curtainsider	<b>205 EUR</b> CS920000150



### Equipment package

incl. preinstalled equipment package consisting of

- 1 skimmer, incl. filter cartridge and skimmer basket
- 1 inlet jet 105, R 1 ½" 4 x 8 mm, V4A
- 1 winter plug for inlet jet 105 (delivered separately)
- 1 safety overflow fitting WP 133
- 1 underwater light LED warm white
- 1 transformer 100 VA and 1 deck box (delivered separately)

incl.

### Aqua Fun 4.0

#### 4-jet flow & massage system (second technique shaft required)

The four jet nozzles of the Aqua-Fun 4.0 bring a strong current into the water. Furthermore, individual body parts can be massaged selectively, consisting of:

- 4 Turbojet-Slimline massage-nozzles
- Jet pump 2,6 kW / 400V
- 1 pneumatic switch with 10 m PN hose
- PN switch box 400 V with contactor up to 2 kW ( 4 - 6A )
- 2 suction fittings polished

ATTENTION: The jet pump must always be installed below the water level. Please also note that you need an additional technique shaft for this pump.

5.725 EUR

### Cascade "Maine"

Cascade "Mini V4A" consisting of:

- 1 x stainless steel cascade Mini V4A
- 1 x 1 jet pump 1,0 kW 230 V with PN switch box
- 1 x pneumatic switch with 5 m PN hose
- 2 x suction fittings

(pump is delivered either loose or installed in the optional technique shaft)

Note: without PN switch in combination with technical package with Spa Touch display

2.684 EUR

**Technical equipment** required





## Cascade "Cube"

### V4A stainless steel cascade with push button in the pool

- 1 x cascade "Cube" (delivered separately)
- 1 x pneumatic switch 107/1 V4A (mounted) with 10 m PN hose and 10 m protective hose (delivered separately)
- 1 x jet pump with PN switch box
- 2 x suction fittings with stainless steel cover (mounted)

Note: without PN switch in combination with technical package with Spa Touch display

**3.550 EUR**

**Technical equipment** required



## Spa-Massage-Pak

- 2 x Turbojet-Slimline massage-nozzles for the lower back
- 4 x Microjet-Slimline massage-nozzles for neck and shoulders
- 2 x suction fittings, polished
- 1 x pneumatic switch with 5 m PN hose
- 1 x jet pump 230 V with PN switch box  
(pump is delivered either loose or installed in the optional technical shaft)

Note: without PN switch in combination with technical package with Spa Touch display

**2.358 EUR**

**Technical equipment** required



## 4 x vertical inlets

- installed in the entry area
- including 4 B141x winter plugs, 28/35 x 35 mm

**593 EUR**



### Manual vacuum cleaner

#### PVC blue

Remove the dirt from your CSIDE with light manual pumping movements. With removable, very fine filter, which can be easily rinsed out.

Total length: 148 cm

Colour: PVC-blue

Suction width: 8 cm

**231 EUR**



### Suction fitting d130

(only needed additionally if you want to connect a sand filter)

- straight wall duct
- polished stainless steel
- hair safe according to DIN 13451
- Qmax = 8.1 m<sup>3</sup>/h

**221 EUR**



### Bottom outlet, elbow 90°

(only required if you want to empty the basin completel)

- Red brass 1 1/2" f

**273 EUR**





### Spare cartridge

Spare cartridge for cartridge filter

**79 EUR**



### Inlet fitting 1 1/2"

red brass with plastic face plate, black or white

**310 EUR**



### Piping material

for connecting the pool and technical shaft or heat pump

25m flexible hose, 50 mm  
4 x reduction, 90°, 50 f/m  
4 x elbow, 90° 2 x socket, 50 x 50 f/m  
1 x Tangit cleaner 125 ml  
1 x Griffon PVC glue WDF-05

**252 EUR**



### surface care set

For the ideal treatment of the pool surface

Consisting of:

1 each of Pool Finish, Gel Edge Cleaner, Antigilb, stainless steel polish, gloves, microfibre cloth polishing cloth, polishing set, sponge, care instructions for swimming pools (Technical Info SB 9)  
4 x each 1000-, 2000-grit wet sandpaper and 800-grit sandpaper

**147 EUR**





### **water care set HTH**

consisting of:

- 1 x Lovibond pool tester
- 1 x HTH pH-Plus 5 kg
- 1 x HTH Briquettes 7 g, 2.5 kg inorganic UN-1748, Calcium hypochlorite, mixture, dry, 5.1, III, (E),
- 1 x HTH - pH Minus 5 kg
- 1 x HTH - Alkanal 5 kg
- 1 x Chlorine doser "Swim"

**263 EUR**

## Coping



### **Coping stones Granite, grey for CS 37+ shallow water zone**

Coping stones with overhanging nose  
Dimensions: 60x60x6/3, mottled surface

**4.711 EUR**



### **Dekor-Fliesen für CSide37L mit Wetlounge**

aus Ezarri Glasmosaik, werkseitig angebracht und verfugt

Oberhalb der Rollladenauflaufkante, Höhe 21cm

**1.964 EUR**



### Technique shaft XL

incl. cover 1064 x 726 x 650 mm

Technique shaft XL  
incl. cover 1064 x 726 x 650 mm  
technical package, installed in technique shaft, consisting of:  
- technique shaft XL  
incl. inspection platform, shaft drain and cable bushing  
(article only available in connection with a technical package)

Note:  
Technique shafts must ALWAYS be installed below water level.

Please note that the technology mounted in the shaft ALWAYS needs to be installed below the water level.

1.943 EUR

Technical equipment required



### Technical package for half-year use

Technical equipment with filter pump and bypass for a heat pump

This technical package can be used from spring to autumn. The pool is heated by an optional heat pump. When the outside temperature is above 10°C, the water can be heated up to 28°C. The distance between pool and equipment should not exceed 5 m. Technical package can also be installed above water level.

Technical equipment mounted on a pallet consisting of:

- Self-priming filter pump 0.75 kW-230 V
- Check valve for filter pump
- Bypass for an optional heat pump
- Filter pump control mounted on inspection platform
- Connected load: 1 x 16 Ampere - 230 V
- Size 120 cm x 80 cm (length x width)

1.765 EUR



### Heat pump HKR 6 kW

For the heating of your C-SIDE

Dimensions: 790 x 330 x 580 mm  
Weight: approx. 36 kg  
Hydraulic connection adhesive screw connection d 50  
Performance data:  
Heat output A 15°/W 26° = 4,25kW  
Heating capacity A 26°/W 26° = 6 kW  
Cooling capacity approx. 4kW  
Power consumption approx. 1.04 kW  
Current consumption nominal 5A, fuse 16A C (slow blow)  
Water flow rate > 2,3m³  
Pressure loss heat exchanger kPa=2,4  
Volume level in 10/1 mtr. approx. 38/50 dB(A)

Functionality starting at an outdoor temperature of 10 degrees.

1.865 EUR





### Technique shaft XXL, incl. preparation for dosing system (dosing system not included)

incl. cover (1600 x 900 x 670 mm)

technical package, installed in technique shaft, consisting of:  
- technique shaft XXL incl. inspection platform, shaft drain and cable bushing  
(article only available in connection with a technical package)

Note:  
Technique shafts must ALWAYS be installed below water level.

**2.679 EUR**



### Terminal for Spatouch display

stainless steel, ground surface

height: 1.000 mm

**462 EUR**

Technical package with Spatouch-display required



### Surcharge for electric heater 9 kW

total capacity: 3 kW + 9 kW

Upgrade for the technical package with Spatouch-display with a stronger electric heater, that allows to heat up the water more quickly.

Preinstalled on the technical package  
Connected load: 1 x 16 Ampere - 230 V, 1 x 16 Ampere - 400 V  
An insulating pool cover is required to heat up the pool efficiently.

**1.155 EUR**

Technical package with Spatouch-display required

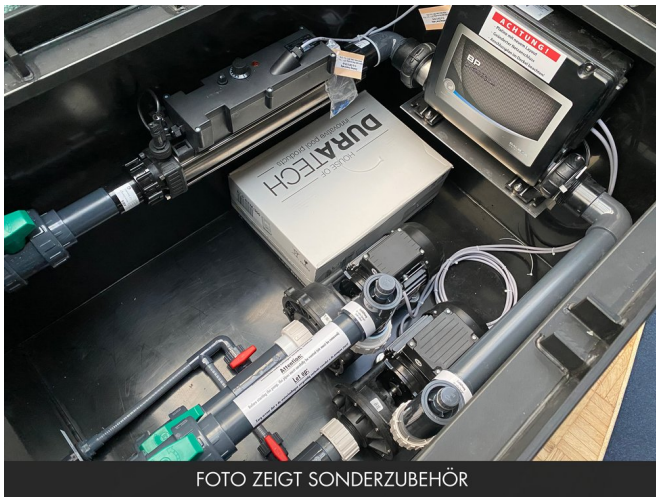

## Technical package with Spatouch-display

with frost protection, suitable for winter use

Technical equipment designed for automatic year-round use. The pool is heated by the electric heater. The distance between pool and equipment should not exceed 5 m.

Technical equipment mounted on a pallet consisting of:

- Self-priming filter pump 0.75 kW-230 V
- Pool-Control with Spatouch-display and temperature control and remote control (Spa touch-display and IR-receiver are delivered separately)
- electric heaters 230 V, 1 x 3 kW / 1 x 2 kW
- connected load: 2 x 16 Ampere

Note:

max. water temperature: 32°C for colours papyrus, silver grey and granicite stonegrey

max. water temperature: 38°C for mosaic tiled pools

**3.519 EUR**

## Lighting



### WetLounge lighting in warm white

- 2 x LED underwater lights, warm white
- 2 x deck box (KU)

on request



### WetLounge lighting in RGB

- 2 x LED underwater lights RGB
- 2 x deck box (KU)

on request



### Surcharge for 1x LED RGB light

#### Coloured LED light

1 x underwater light LED RGB (HT) with DMX control box and remote control

956 EUR





### **Surcharge for 2 x LED RGB light**

#### **Coloured LED light**

2 x underwater light LED RGB (HT) with DMX control box and remote control and second deck box (KU)

**2.059 EUR**



### **Additional underwater light LED warm white**

1 x underwater light LED warm white (HT), transformer 100 VA and second deck box (KU)

**893 EUR**



### **Surcharge for fixed date (day) delivery**

**Delivery to the dealer**

**205 EUR**

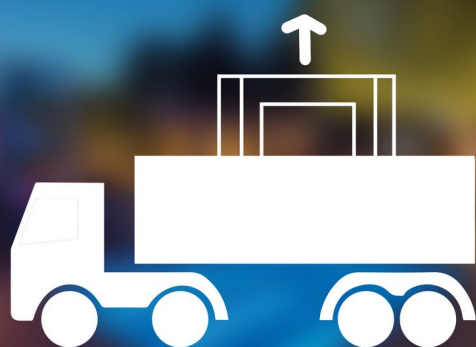

### **Surcharge for delivery by a curtailer**

**crane unloading on site**

Forwarding truck is to be opened at the top. This allows a crane to lift the pool out of the truck.

**205 EUR**

## C-SIDE REFERENCES

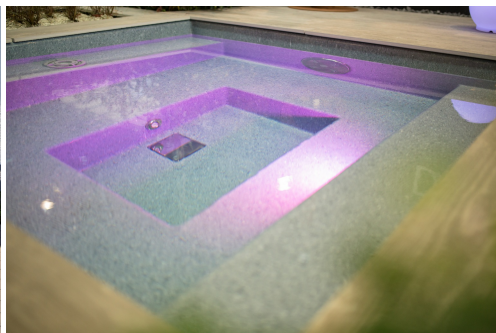

## YOUR C-SIDE DEALER

**CSIDE**  
**POOLS**

### Partner Line

Geithus Næringspark, Gravfossveien 1  
3360 Geithus  
+4791651309  
[roy.paulsen@partnerline.no](mailto:roy.paulsen@partnerline.no)